

Exhibit F

June 2014 Amendment to the 2009 General Project Plan

Exhibit F

NEW YORK STATE URBAN DEVELOPMENT CORPORATION
dba EMPIRE STATE DEVELOPMENT

ATLANTIC YARDS LAND USE IMPROVEMENT AND CIVIC PROJECT

June 2014 Amendment to the 2009 Modified General Project Plan

Except as modified below, the Project's 2006 Modified General Project Plan, affirmed by the ESD Directors on December 8, 2006, as thereafter first amended in the 2009 Modified General Project Plan, affirmed by the ESD Directors on September 17, 2009 (collectively, the "2009 MGPP"), remains unmodified and in full force and effect. The Amendment is as follows:

1. In Exhibit C to the 2009 MGPP (entitled "Atlantic Yards Building Heights & Square Footages (revised)") delete "4,434,000" in the row entitled "Phase Two Total Not to Exceed" and insert in place thereof "4,642,000". This modification allows shifting up to 208,000 GSF of floor area from Phase I to Phase II of the Project, but it does not change: (a) the total maximum GSF of the Project (Phase I + Phase II) as a whole, which would remain at 7,125,000 GSF (excluding the arena); or (b) the maximum GSF of each or any individual Project building, inclusive of those Phase II buildings to which the GSF may be transferred.
2. In Section E4 of the 2009 MGPP at page 15, delete the following sentence: "There would also be approximately 2,346 parking spaces at the end of Phase I, which would include permanent parking on the Arena Block and Site 5 and interim surface parking on Block 1129 and possibly Block 1120." In place thereof, insert the following sentence: "At the end of Phase I, the approximate number of parking spaces to be provided would be equal to the sum of 360 parking spaces and 0.2 parking spaces for each Phase I market-rate residential unit, which would include permanent parking on the Arena Block and Site 5 and interim surface parking or permanent below-grade parking on Block 1129." In the last line of page 16 of the 2009 MGPP, delete "approximately 3,670 permanent parking spaces" and insert in place thereof "approximately 1,200 permanent parking spaces." In the first sentence of Section E7 of the 2009 MGPP, at page 18, delete "approximately 3,670 below-grade parking spaces" and insert in place thereof "approximately 1,200 below-grade parking spaces."
3. Delete the Parking Key Plan attached as Exhibit D to the 2009 MGPP in its entirety and insert a new Parking Key Plan, as depicted in Exhibit D-1 ("Parking Key Plan, Reduced Parking Alternative") attached to this June 2014 Amendment to the 2009 MGP.

Exhibit D-1

0.10.14

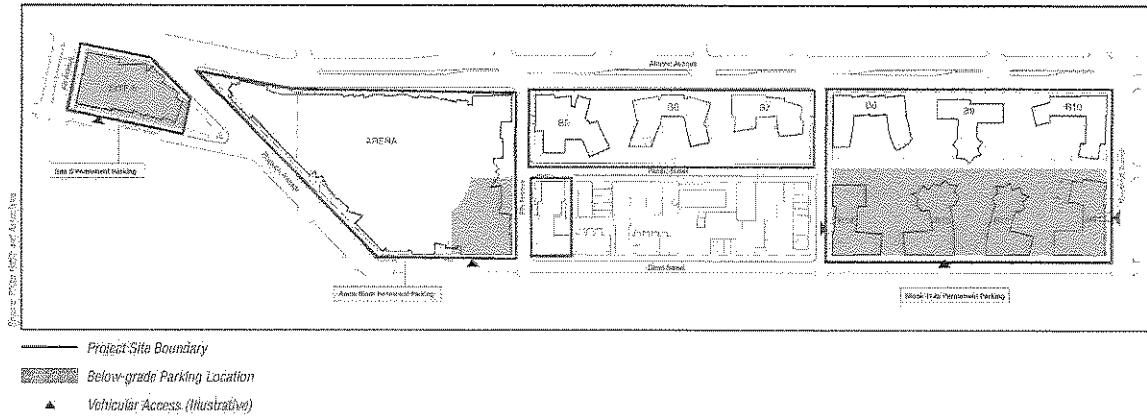

Atlantic Yards Parking Key Plan, Reduced Parking Alternative